

THE ORKNEY ISLANDS COUNCIL (40 MPH SPEED LIMIT) (VARIOUS SCHOOLS IN ORKNEY) ORDER 2011

The Orkney Islands Council in exercise of its powers under Section 84 of the Road Traffic Regulation Act 1984 ("the Act"), and of all other enabling powers, and after consultation with the chief officer of police in accordance with Part III of Schedule 9 to the Act, hereby makes the following Order:-

- 1 This Order may be cited as The Orkney Islands Council (40 mph Speed Limit) (Various Schools in Orkney) Order 2011 and shall come into operation on the Eighteenth day of July Two Thousand and Eleven.
- 2 The Interpretation Act 1978 shall apply for the interpretation of this Order as it applies for the interpretation of an Act of Parliament.
- 3 No person shall drive or cause or permit to be driven any motor vehicle at a speed exceeding forty miles per hour in any of the lengths of road specified in the Schedule to this Order.

Given under the seal of Orkney Islands Council on the Fourteenth day of June Two Thousand and Eleven



Chief Executive



SCHEDULE

- (a) That part of the public road B9047 leading from Lyness to Longhope outside North Walls Junior High School from a point One Hundred and Thirty metres or thereby northwest of the access to the property known as Halla to a point Forty metres or thereby north of the access to the property known as Swartland, a total distance of Six Hundred metres or thereby; together with that part of the public road known as Crookness Road leading from its junction with the B9047 for a distance of Fifty metres or thereby, a total distance of Fifty metres or thereby, all as shown in red on Plan 1 annexed and executed as relative to this Order
- (b) That part of the public road B9046 leading from the B9045 to Pan Pier outside Flotra Primary School from a point of Thirty metres or thereby east of its junction with the public road known as the B9045 to a point Seventy Five metres or thereby west of Bow Road, a total distance of Six Hundred metres or thereby, as shown in red on Plan 2 annexed and executed as relative to this Order
- (c) That part of the public road B9060 from its junction with the B9062 to its junction with B9061 outside Stronsay Junior High School from a point Fifty metres or thereby northwest of the access to the property known as Warthill to a point Seventy metres or thereby northwest of the access to the property known as Hillcrest, a total distance of Six Hundred metres or thereby; together with part of the public road known as Geramont Road, Stronsay from its junction with the B9060 for a distance of Thirty metres or thereby, a total distance of Thirty metres or thereby, all as shown red on Plan 3 annexed and executed as relative to this Order.
- (d) That part of the public road B9063 leading from Backaland to Essonquoy outside Eday Primary School from a point Ten metres or thereby north of the access to the property known as Backaland Cottage to a point Fifty metres or thereby north of the access to the property known as Stenaquoy, a total distance of Six Hundred metres or thereby, as shown in red on Plan 4 annexed and executed as relative to this Order
- (e) That part of the public road known as Airfield Road outside Sunday Junior High School from a point Three Hundred metres or thereby west of its junction with School Road to a point Three Hundred metres or thereby east of its junction with School Road, a total distance of Six Hundred metres or thereby, as shown in red on Plan 5 annexed and executed as relative to this Order; together with that part of the public road known as School Road outside Sanday Junior High School from its junction with the Airfield Road to a point Eighty Five metres or thereby north of the access to the property known as Hill House, a total distance of Three Hundred metres or thereby, all as shown red on Plan 5 annexed and executed as relative to this Order
- (f) The public road known as School Road outside Papa Westray Primary School from its junction with the public road known as Central Road to the pier, a total distance of One Thousand and Ninety metres or thereby, as shown red on Plan 6 annexed and executed as relative to this Order
- (g) That part of the public road B9064 outside Rousay Primary School from a point Sixty metres or thereby southeast of the access to the property known as Quoys to a point One Hundred and Twenty metres or thereby south of the public road known as Nethermill Road, a total distance of Seven Hundred and twenty metres or thereby, as shown red on Plan 7 annexed and executed as relative to this Order





Chief Executive

PLAN 1

Reproduced by permission of Ordnance Survey on behalf of HMSO.
 © Crown copyright and database right 2011. All rights reserved.
 Ordnance Survey License number 100021621.

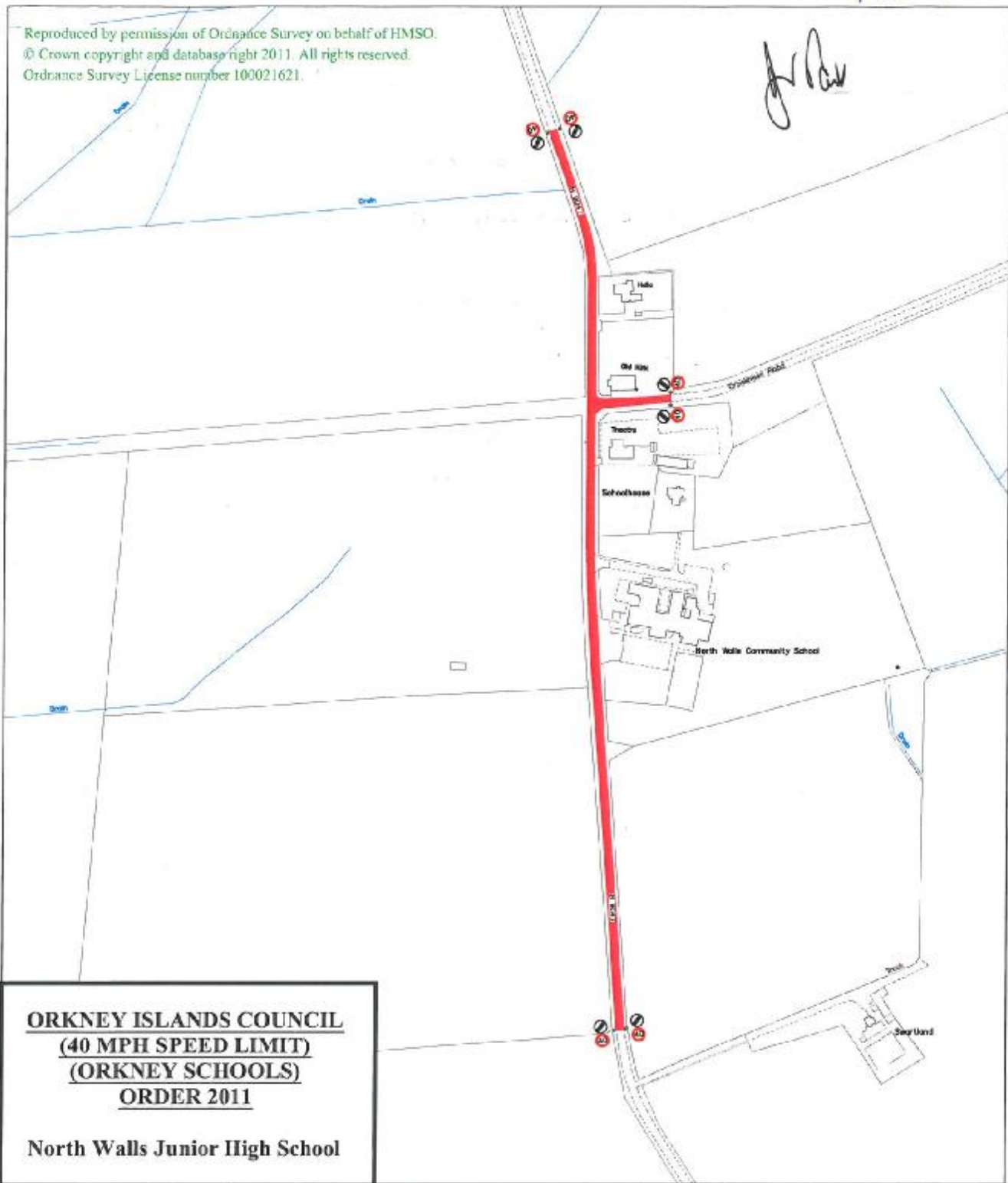
J. Blair



ORKNEY ISLANDS COUNCIL
(40 MPH SPEED LIMIT)
(ORKNEY SCHOOLS)
ORDER 2011

North Walls Junior High School

File Ref. R3.46.04 . 0209	Drg. No. SLR - 1
Revision	
Date 12 January 2011	Drawn <i>L M Birss</i>
Scale Not to Scale	Checked <i>K D Roy</i>

ROADS SERVICES

Development and Environment Services
 Council Offices, Kirkwall
 Orkney, KW15 1NY
 tel (01856) 873535 fax (01856) 876094
 Director :-
 Brian Thomson
 BSc CEng MICE MIHT



C:\projects\roads\divisions\roads\supp\proj\03\R3.46.04\0209 speed limit\Reserve\North Walls Junior High School.dwg

J.P. [Signature]

Plan 2

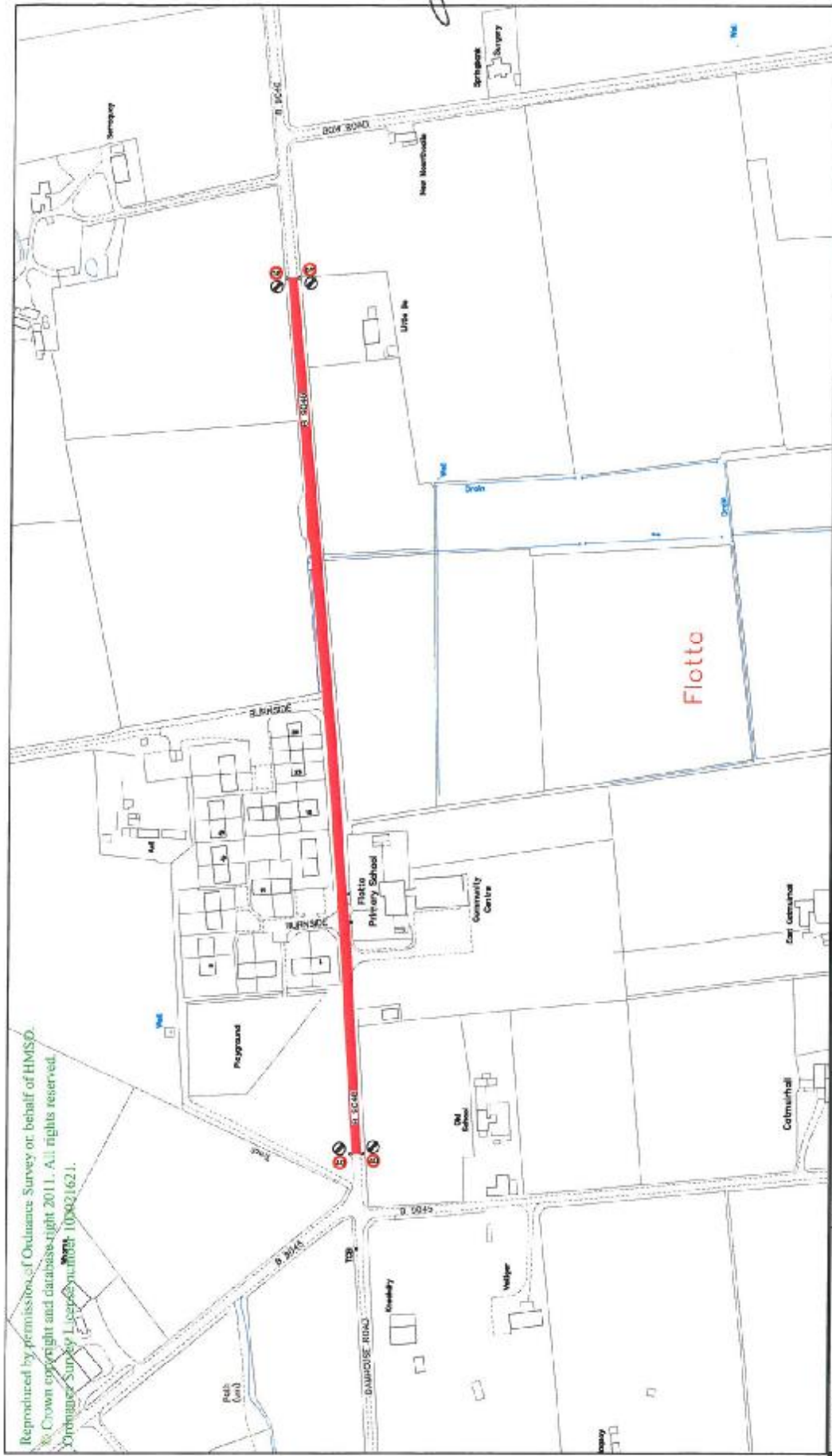

Reproduced by permission of Ordnance Survey on behalf of HMSO.
 © Crown copyright and database right 2011. All rights reserved.
 Ordnance Survey Licence number: 1000421621.

Development and Environment Services
 Council Offices, Kirkwall
 Orkney, KW15 1NY
 tel (01856) 873535
 fax (01856) 876094
 Director :-
 Brian Thomson
 BSc CEng MICE MIHT



Roads Services

ORKNEY ISLANDS COUNCIL
(40 MPH SPEED LIMIT)
(ORKNEY SCHOOLS)
ORDER 2011
Flotta Primary School

File Ref.	R3.46.04 - 0209	Drg. No.	SLR - 2
Revision		Drawn	L M Birrell
Date	24 January 2011	Checked	K D Roy
Scale	Not to Scale		

Original drawing size 297mm x 210mm (A4)

Plan 3

Reproduced by permission of Ordnance Survey on behalf of HMSO.
© Crown copyright and database right 2011. All rights reserved.
Ordnance Survey License number 100021621.

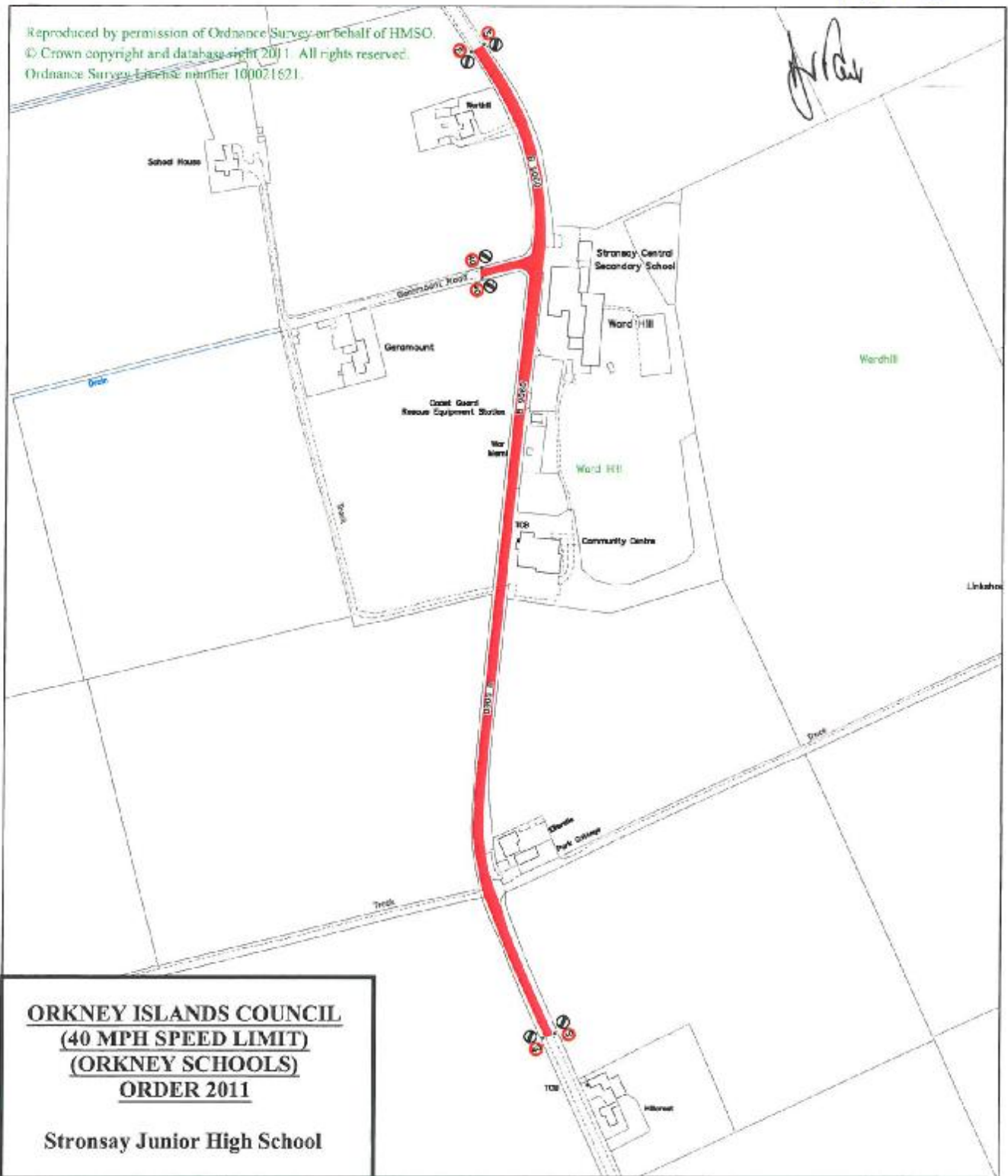

ORKNEY ISLANDS COUNCIL
(40 MPH SPEED LIMIT)
(ORKNEY SCHOOLS)
ORDER 2011

Stronsay Junior High School

File Ref.	Drg. No.
R3.46.04 . 0209	SLR - 3
Revision	
Date	Drawn
12 January 2011	L M Birss
Scale	Checked
Not to Scale	K D Roy

ROADS SERVICES

Development and Environment Services

Council Offices, Kirkwall
 Orkney, KW15 1NY
 tel (01856) 873535 fax (01856) 876094

Director :-
 Brian Thomson
 BSc CEng MICE MIHT



G:\projects\roads\council\support\project\road\04\0209\slr\3\Drawn\secondary_council_high_school.dwg

Plan 4

Reproduced by permission of Ordnance Survey on behalf of HMSO.
 © Crown copyright and database right 2011. All rights reserved.
 Ordnance Survey License number 100021621.

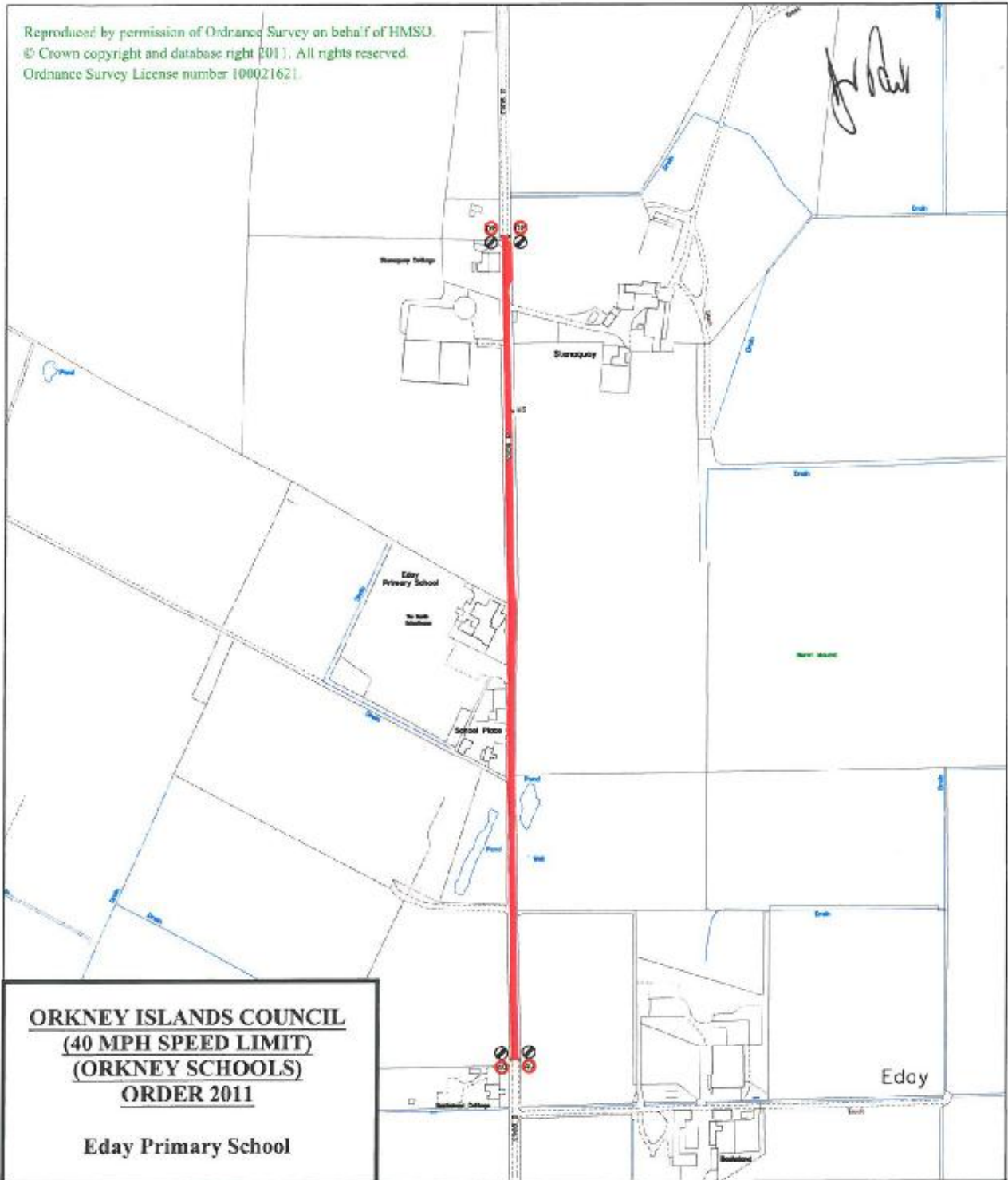

ORKNEY ISLANDS COUNCIL
(40 MPH SPEED LIMIT)
(ORKNEY SCHOOLS)
ORDER 2011

Eday Primary School

File Ref. R3.46.04 . 0209	Drg. No. SLR - 4
Revision	
Date 24 January 2011	Drawn LM Birss
Scale Not to Scale	Checked KD Roy

ROADS SERVICES

Development and Environment Services
 Council Offices, Kirkwall
 Orkney, KW15 1NY
 tel (01856) 873535
 fax (01856) 876094

Director :-
 Brian Thomson
 BSc CEng MICE MIHT



Plan 5

Reproduced by permission of Ordnance Survey on behalf of HMSO
© Crown copyright and database right 2011. All rights reserved.
Ordnance Survey License number 100021621.

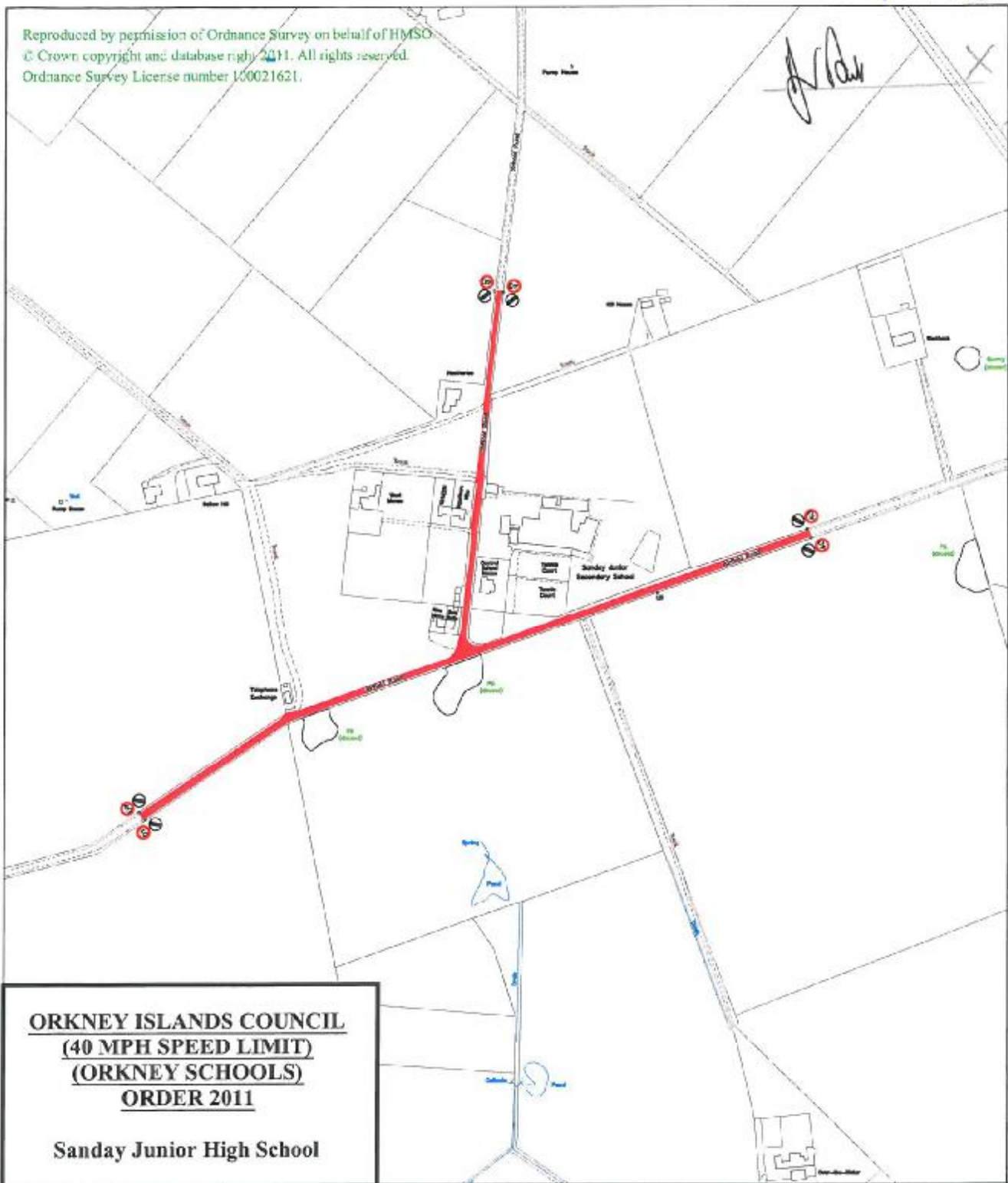

ORKNEY ISLANDS COUNCIL
(40 MPH SPEED LIMIT)
(ORKNEY SCHOOLS)
ORDER 2011

Sanday Junior High School

File Ref.
R3.46.04 . 0209

Drg. No.
SLR - 5

Revision

Date
24 January 2011

Drawn
L M Birss

Scale
Not to Scale

Checked
K D Roy

ROADS SERVICES

Development and Environment Services

Council Offices, Kirkwall
Orkney, KW15 1NY
tel (01856) 873535
fax (01856) 876094

Director :-
Brian Thomson
BSc CEng MICE MIHT



ORKNEY
ISLANDS COUNCIL

15:\p\main\1106\01106\plans\supp\orig\slr-5-40-40-20-09-speed-limit-renew-sanday-junior-high-school.dwg

J. Dav

Plan 6



Reproduced by permission of Ordnance Survey on behalf of HMSO.
 © Crown copyright and database right (2011). All rights reserved.
 Ordnance Survey License number 100021621.

File Ref.	R3.46.04 . 0209	Drg. No.	SLR - 6
Revision		Drawn	L M Bury
Date	24 January 2011	Checked	K D Roy
Scale	Not to Scale		
ORKNEY ISLANDS COUNCIL (40 MPH SPEED LIMIT) (ORKNEY SCHOOLS) ORDER 2011			
Papa Westray Primary School			
<p>Roads Services</p> <p>Development and Environment Services Council Offices, Kirkwall Orkney, KW15 1NY tel: (01856) 873535 fax: (01856) 876094 Director :- Brian Thomson BSc CEng MICE MIHT</p>			

Original drawing size 297mm x 210mm (A4)

Reproduced by permission of Ordnance Survey on behalf of HMSO.
 © Crown copyright and database right 2011. All rights reserved.
 Ordnance Survey license number 100021621.

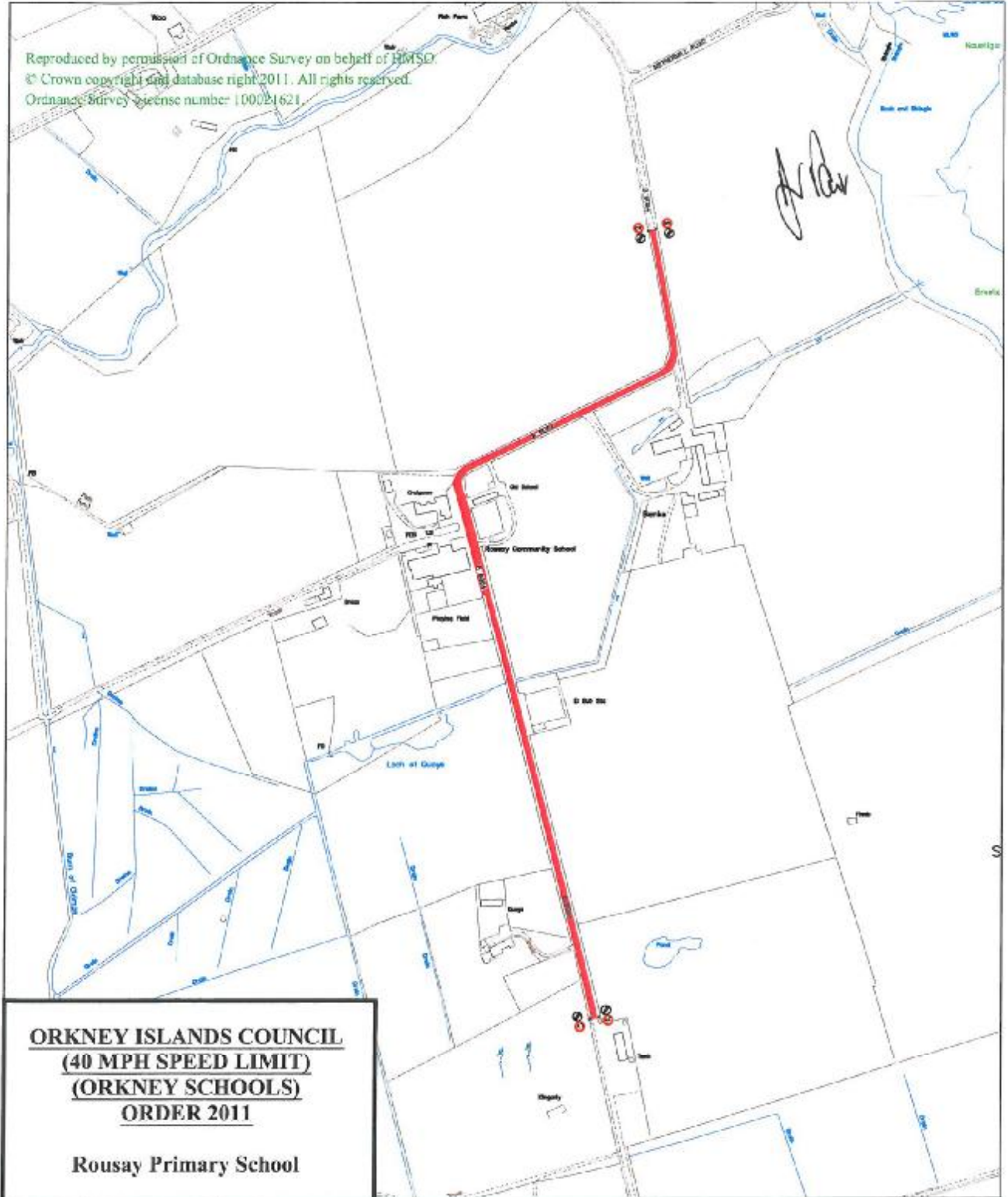

ORKNEY ISLANDS COUNCIL
(40 MPH SPEED LIMIT)
(ORKNEY SCHOOLS)
ORDER 2011

Rousay Primary School

File Ref. R3.46.04 . 0209	Drg. No. SLR - 7
Revision A	Drawn LM Birss
Date 25 January 2011	Checked KD Roy
Scale Not to Scale	

ROADS SERVICES

Development and Environment Services

Council Offices, Kirkwall
 Orkney, KW15 1NY
 tel (01856) 873535
 fax (01856) 876094

Director :-
 Brian Thomson
 BSc CEing MICE MIHT

