

**Key**

- Extent of Licensed Premises
- Extent of Children/Young Persons Accessible area.
- EXIT Running Man Illuminated Exit Sign
- S Smoke Detector

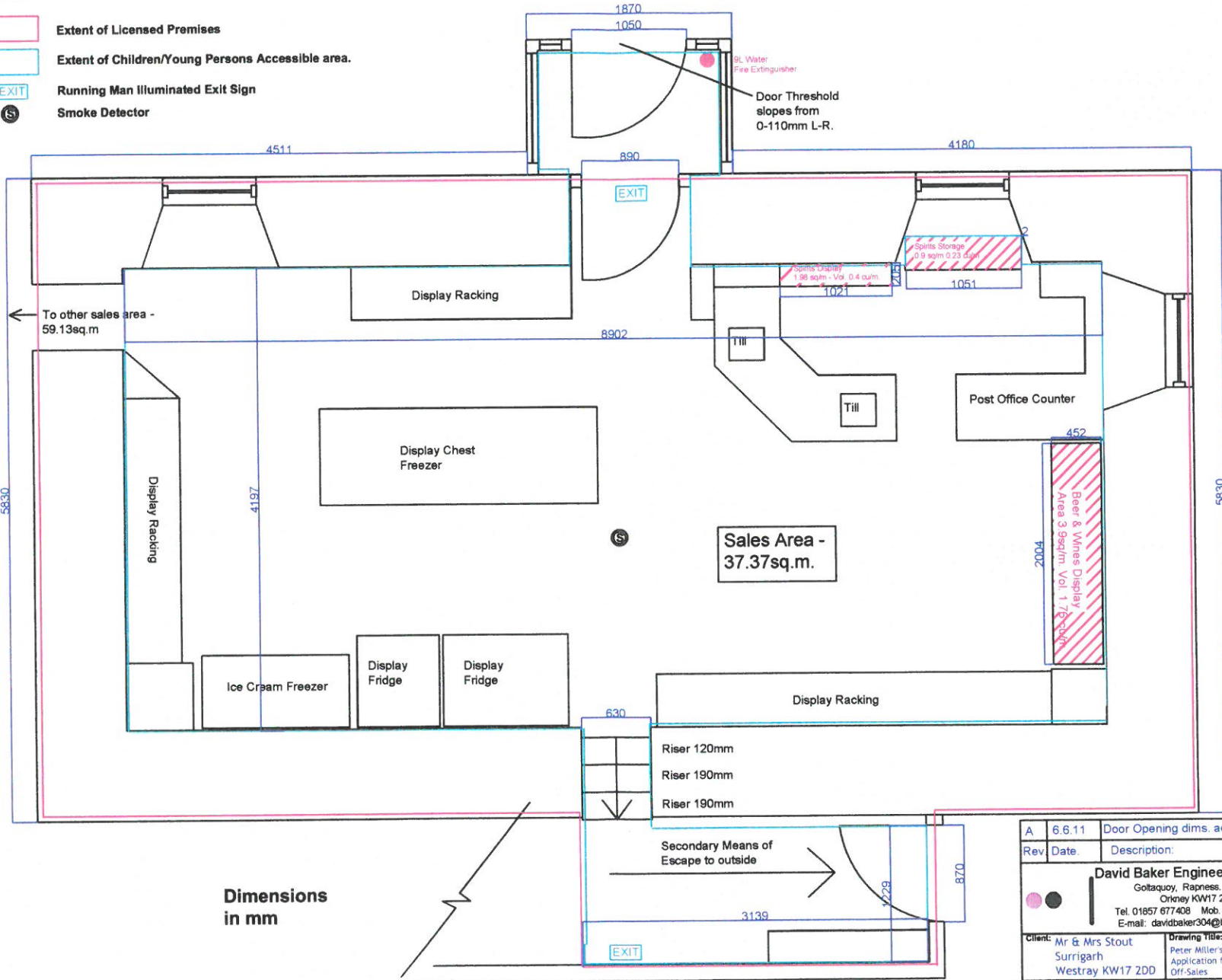

Dimensions in mm

A	6.6.11	Door Opening dims. added	DB
Rev	Date	Description:	Dm. Chk.
<b>David Baker Engineering Services</b> Goltacooy, Rapness, Westray, Orkney KW17 2DE Tel. 01857 677408 Mob. 07547 720096 E-mail: davidbaker304@btinternet.com			
Client: Mr & Mrs Stout Surrigarh Westray KW17 2DD		Drawing Title: Peter Miller's Shop Application for Alcohol Off-Sales	
Scale: 1:50	Drawn By: DJB	Checked By:	Drawing Number: DBES/06/001 Rev. A